

An aerial photograph showing several large, circular solar collectors (heliostats) arranged in a desert landscape. The collectors are dark green and have a concentric circular pattern. They are surrounded by a light-colored, sandy or rocky terrain. The sky is a pale, hazy blue. The overall composition is abstract due to the circular shapes and the high-angle perspective.

OBEX™

Milliken
Entrance Flooring

ROLL & MAT

Milliken™



OBEX™ Roll

Featuring a durable vinyl backing with multiple colour options, OBEX™ Rolls allow for seamless transitions into hallways and larger spaces. Rolls can be cut to produce runners or installed wall-to-wall, protecting against dirt and moisture in high-traffic areas and heavy commercial use.

ZONE 2 | ZONE 3

MATERIALS

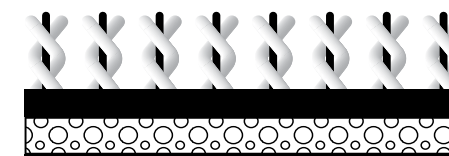

Cut (Z2, Z3)



Dark Grey



Grey



Dark Blue



Brown

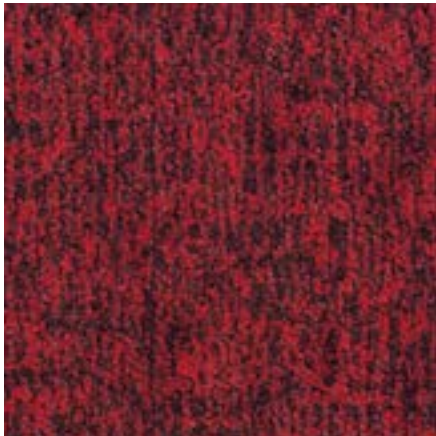

Red



▶ Z3: Roll / Cut / Galaxy / Grey



OBEX™ Mat

OBEX™ Mats combine protection with flexibility. Whether applied as a primary barrier system or as a temporary, loose-laid option when additional protection is needed, Mats capture fine dirt, larger particles, and moisture.

ZONE 1 | ZONE 2 | ZONE 3

MATERIALS

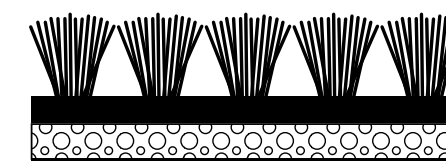

Mono (Z1, Z2)

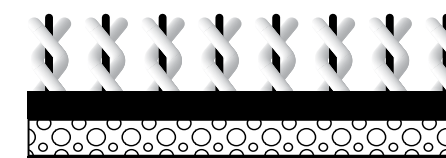

Cut (Z2, Z3)



▶ Z3: Mat / Cut / Galaxy / Brown

OBEX™ Mono | Z1, Z2



Grey

OBEX™ Cut | Galaxy | Z2, Z3



Dark Grey



Grey



Dark Blue



Brown



Red

Covering the Zones

Protection from the Outside In

To determine the most effective OBEX™ solution, our team evaluates your building's entry based on three distinct Zones. This process starts at the outside of the building, and addresses the entire pathway through any airlocks, vestibules, and lobby or reception areas. Because every facility is unique, breaking down these Zones helps define where entrance flooring should be installed, as well as what combinations of Forms and Materials will deliver the best protection and performance.

ZONE 1 | OUTDOORS

Location: Outdoor area prior to building's entrance

Recommendation: Product with heavy scraping action

Goal: Trap grit, heavy dirt particles, and moisture, including snow, salt, and sand

ZONE 2 | VESTIBULE / AIRLOCK

Location: Enclosed entrance of building

Recommendation: Dual-action product that combines scraping and absorption

Goal: Collect dirt, debris, and moisture

ZONE 3 | INDOORS

Location: Primary area(s) inside building

Recommendation: Product with high absorption qualities

Goal: Remove remaining moisture and small particles

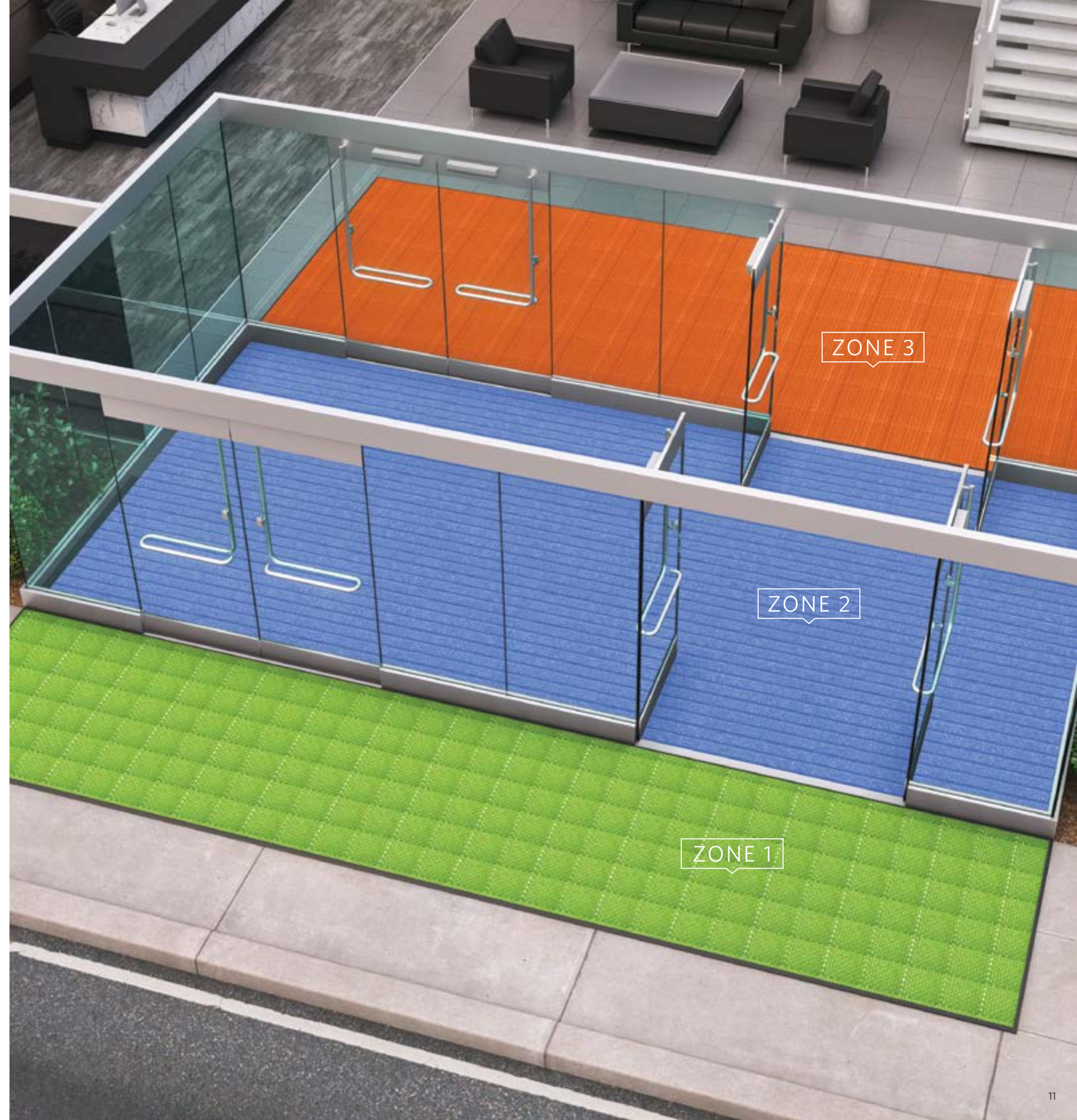

ZONE 3

ZONE 2

ZONE 1



Introducing **OBEX[™] VIA**

Our **Variable Installation Approach (VIA)** means you don't have to settle for generic, one-size-fits-all entrance flooring.

OBEX[™] VIA is our site-specific analysis that starts with an assessment of your facility's unique environment, specific needs, and challenges.

We then match your requirements with our offering of effective Forms and industry-proven Materials.

Finally, VIA focuses the conversation on your preferences, resulting in a tailored entrance flooring system that delivers both performance and protection.

- O** **Objective – What do you need your entry to do?**
Factor in variables such as weather conditions and the intensity of foot, rolled, and heavy cart traffic.
- B** **Barrier Level – Where and to what degree do you need protection?**
Assess each Zone along the entry pathway, including vestibules, lobbies, and transition areas to determine available linear walk-off distance.
- E** **Enhance – What look and style do you want?**
Review options for colour and pattern, as well as coordination with interior flooring products and any identity branding you may want.
- X** **Execute**
Based on your answers to the previous questions, we can now identify and recommend the most effective, customised system of OBEX[™] Forms and Materials.

Mat & Roll Specifications

OBEX™ MONO

Construction
Tufted, Cut Pile

Standard Mat Size
85 x 60 cm 85 x 120 cm
85 x 150 cm 85 x 200 cm
115 x 200 cm 115 x 180 cm
115 x 300 cm 115 x 240 cm
150 x 200 cm 150 x 300 cm

Textile Yarn Type
100% ECONYL® Regenerated BCF
Polyamide, Twisted & Heat-Set
Monofilaments

OBEX™ CUT

Construction
Tufted, Cut Pile

Standard Roll Size
2 m x 25 m

Standard Mat Size
85 x 60 cm 85 x 120 cm
85 x 150 cm 85 x 200 cm
115 x 200 cm 115 x 180 cm
115 x 300 cm 115 x 240 cm

Textile Yarn Type
100% ECONYL® Regenerated BCF Polyamide,
Twisted & Heat-Set Multi/Monofilaments
Dual Fibres



Quick Reference Guide

Form - Material	Zone Application			Dirt/Debris Removal			Moisture Absorption			Installation Approach		
	Z1	Z2	Z3	Good	Better	Best	Good	Better	Best	Recessed	Surface	Wall to Wall
Bar - Mono 11mm	•	•				•				•	•	•
Bar - Mono 16mm	•	•				•				•		
Bar - Cut 11mm		•				•			•	•	•	•
Bar - Cut 16mm		•				•			•	•		
Half Bar - Mono 11mm	•	•				•				•	•	•
Half Bar - Mono 16mm or 22mm	•	•				•				•		
Half Bar - Cut 11mm		•				•			•	•	•	•
Half Bar - Cut 16mm or 22mm		•				•			•	•		
Grid - Vinyl Open 11mm	•				•					•	•	•
Grid - Vinyl Closed 11mm or 16mm		•			•					•	•	•
Grid - Mono Open 11mm	•					•				•	•	•
Grid - Mono Closed 11mm or 16mm		•				•				•	•	•
Grid - Cut Open 11mm		•				•			•	•	•	•
Grid - Cut Closed 11mm or 16mm		•				•			•	•	•	•
Tile - Cut		•	•		•				•	•	•	•
Tile - Loop		•	•	•				•		•	•	•
Roll - Cut		•	•		•				•	•	•	•
Mat - Mono	•	•				•					•	
Mat - Cut		•	•		•				•		•	

Milliken's integrated OBEX™ system of Forms and Materials optimises safety, wellness, and design from the outside in.

millikenfloors.com/OBEX



OBEX VIA™

Download the app today.



Augmented
Reality



Product
Catalog



Project
Management

Milliken™